

LIFELIGHT™ Data Sheet

The LIFELIGHT™ delivers a low cost, low maintenance, high performance emergency lighting solution. Achieve higher levels of compliance, cheaper and easier, by using the LIFELIGHT™.

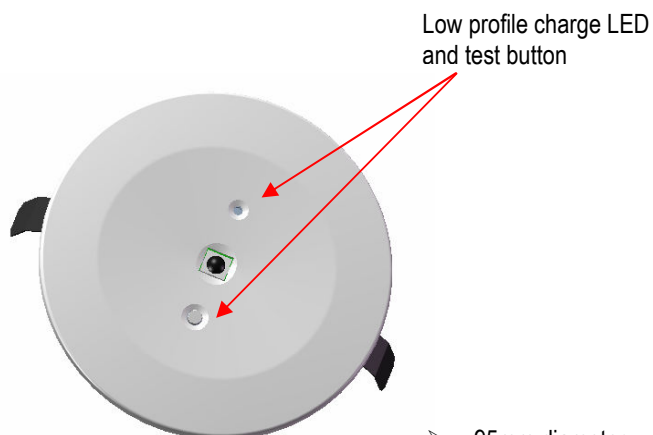

- 95mm diameter
- 85mm round hole
- Cut-out suitable for plaster ceilings
- Spring Clip Mount
- Depth: 50mm

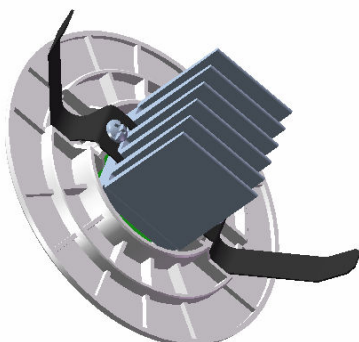

Features

- Aesthetic appeal
- 1 high brightness 97lm/W LED delivering D25, D25 performance comparable to conventional quartz halogen fittings
- Same classification for white and black heads
- Tamper resistant and no dome required
- Ultra-low energy consumption (half the standby energy consumption of the comparable quartz halogen fittings)
- 60% Smaller battery size compared to conventional quartz halogen fittings
- Lifetime lamp warranty
- Available as Premium, Clever-test and Zoneworks at the same price as conventional quartz halogen fittings!

Never need to change a lamp!

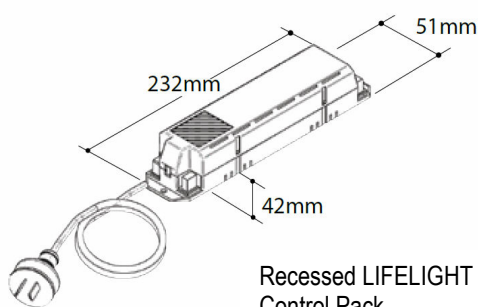

Recessed LIFELIGHT Control Pack

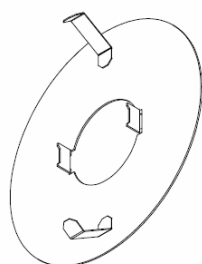

Optional adaptor plate for retro-fit of existing large head QI spinnings.
P/N: PLIFE-ADP

Diameter = 146mm
Cut-out = 130mm

Catalogue Number	PLIFE, DLIFE, ZLIFE
Description	LIFELIGHT™ High performance, recessed emergency light, c/w flex and plug
Operating Mode	Non-Maintained
Mounting	Recessed Ceiling Mount
Lamp	1 x Low Energy, High Brightness Long Life LED, 97lm/W
Supply Voltage	220/240V, 50/60Hz
Battery	4-Cell, Sub-C, High Temperature NiCd
Power Consumption (standby)	2.5W
AS2293 Classification	C0=D25, C90=D25

Please call your nearest Clevertronics® office for your local representative:
Melbourne (Head Office) (03) 9532 0566
Brisbane (07) 3200 2555 Sydney (02) 9674 8944 Adelaide (08) 8339 1092
www.clevertronics.com.au

Due to changes in industry standards and Clevertronics® policy of product improvement, specification details are subject to change without notice.